



ONLY ENGINEER CERTIFIED CARPORTS

(866) 730-9865 | www.americansteelinc.com



Contact your local dealer:

Starting at

\$1,045.00

(14 Gauge) 12' W x 20' L x 6' H
*Pricing for Standard Roof only

STANDARD ROOF

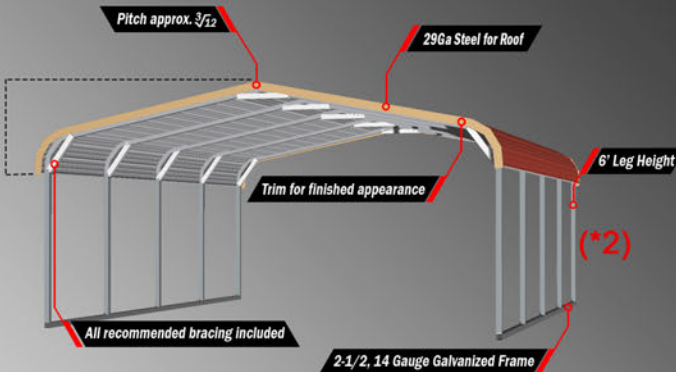

*Std units come with 6" overhang on each end.

A-FRAME VERTICAL

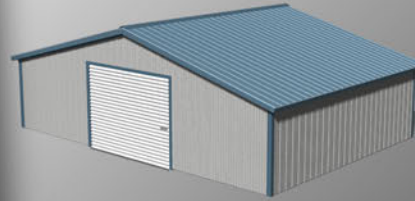

GO VERTICAL

**HIGHLY RECOMMENDED TO GO VERTICAL FOR 35' & LONGER TO AVOID LEAKING.

A-FRAME HORIZONTAL

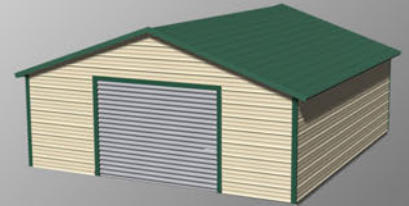

ALL BRACING INCLUDED!

Truss quantity/design may vary according to applicable building codes & standards.

14 Gauge

12x20	\$1,045	18x20	\$1,255	20x20	\$1,780	22x20	\$2,200	24x20	\$2,620	26x20	\$3,200	28x20	\$3,460	30x20	\$3,725
12x25	\$1,570	18x25	\$1,835	20x25	\$2,255	22x25	\$2,780	24x25	\$3,305	26x25	\$3,985	28x25	\$4,300	30x25	\$4,670
12x30	\$1,885	18x30	\$2,200	20x30	\$2,675	22x30	\$3,305	24x30	\$3,935	26x30	\$4,775	28x30	\$5,200	30x30	\$5,560
12x35	\$2,200	18x35	\$2,620	20x35	\$3,145	22x35	\$3,880	24x35	\$4,615	26x35	\$5,615	28x35	\$6,035	30x35	\$6,505
12x40	\$2,515	18x40	\$2,935	20x40	\$3,565	22x40	\$4,405	24x40	\$5,245	26x40	\$6,400	28x40	\$6,925	30x40	\$7,450
12x45	\$2,830	18x45	\$3,305	20x45	\$4,040	22x45	\$5,035	24x45	\$5,930	26x45	\$7,190	28x45	\$7,765	30x45	\$8,395
12x50	\$3,145	18x50	\$3,670	20x50	\$4,460	22x50	\$5,510	24x50	\$6,560	26x50	\$7,975	28x50	\$8,660	30x50	\$9,290

12 Gauge

12x20	\$1,520	18x20	\$1,780	20x20	\$2,045	22x20	\$2,465	24x20	\$2,780	26x20	\$3,410	28x20	\$3,670	30x20	\$3,935
12x25	\$1,885	18x25	\$2,255	20x25	\$2,570	22x25	\$3,095	24x25	\$3,515	26x25	\$4,300	28x25	\$4,565	30x25	\$4,930
12x30	\$2,305	18x30	\$2,675	20x30	\$3,095	22x30	\$3,725	24x30	\$4,195	26x30	\$5,140	28x30	\$5,510	30x30	\$5,875
12x35	\$2,675	18x35	\$3,145	20x35	\$3,565	22x35	\$4,300	24x35	\$4,880	26x35	\$5,980	28x35	\$6,400	30x35	\$6,875
12x40	\$3,040	18x40	\$3,565	20x40	\$4,090	22x40	\$4,930	24x40	\$5,560	26x40	\$6,820	28x40	\$7,375	30x40	\$7,870
12x45	\$3,410	18x45	\$3,985	20x45	\$4,615	22x45	\$5,560	24x45	\$6,245	26x45	\$7,660	28x45	\$8,240	30x45	\$8,870
12x50	\$3,830	18x50	\$4,460	20x50	\$5,140	22x50	\$6,190	24x50	\$6,925	26x50	\$8,500	28x50	\$9,185	30x50	\$9,865

1 YR
WORKMANSHIP WARRANTY

FINANCING AVAILABLE!

AMERICAN STEEL CARPORTS, INC.
Versatile. Strong. Built to last.

TX SHOP / HQ Joshua, TX 76058	NM SHOP Gallup, NM 87301	IN SHOP Mount Summit, IN 47361	PA SHOP Wilkes-Barre, PA 18702	IL SHOP Kewanee, IL 61443
---	------------------------------------	--	--	-------------------------------------

COLOR OPTIONS
(Actual color may vary due to print quality)

SLATE BLUE, PEBBLE BEIGE, EVERGREEN, PEWTER GRAY, EARTH BROWN, WHITE, BURGUNDY, RAHWIDE, BARN RED, CLAY, QUAKER GRAY, BLACK, GALVALUME

FIND US ONLINE! [FACEBOOK.COM /AMERICANSTEELCARPORTS](https://www.facebook.com/americansteelcarports) [INSTAGRAM.COM /AMERICANSTEELING](https://www.instagram.com/americansteeling) [TWITTER.COM /AMERICANCARPORT](https://www.twitter.com/americancarport)

20 YR
12 GAUGE LIMITED WARRANTY

DELIVERY & INSTALLATION INCLUDED (*2)

22 ft wide and up, recommend to use 12 Gauge steel tubing for framing. Extra trusses may be required for heavy snowload. Prices subject to change without notice. Check before purchase to make sure building meets your LOCAL codes. Buildings are certified for 30 lbs. PSF ground. (*1) 2-1/4" 12 Gauge, 20 year limited warranty on rust through of framing assuming normal user care and maintenance. (*2) Delivery and Installation included on flat and leveled land (no slope). Units installed on unlevelled ground will have spacing between base rail and ground. ASCI is not responsible for any spacing being filled, or ground work being done. If extra work is needed due to ground being unlevelled more than 3" extra charge will incur.



www.americansteelinc.com | (866) 730-9865
 We offer the best quality buildings in the carport industry.

CERTIFIED CARPORT OPTION LIST



Roof Options		A-Frame Horizontal Roof (by Length)								Walk-In Door*		
		Width	21' L	26' L	31' L	36' L	41' L	46' L	51' L	W	H	
		12 - 30 Ft	\$100	\$125	\$150	\$175	\$200	\$225	\$250			
Leg Height		A-Frame Vertical Roof (by Length)								36" W x 72" H \$250		
		12 - 18 Ft	\$400	\$500	\$600	\$700	\$800	\$900	\$1,000	36" W x 80" H \$300		
		20 - 22 Ft	\$495	\$620	\$745	\$870	\$995	\$1,120	\$1,245	\$75 Fee for Installation on side wall of Vertical Building		
		24 - 26 Ft	\$595	\$745	\$895	\$1,045	\$1,195	\$1,345	\$1,495	Roll Up Doors*		
		28 - 30 Ft	\$695	\$870	\$1,045	\$1,220	\$1,395	\$1,570	\$1,745			
Closed Sides Both Sides		Height	20' L	25' L	30' L	35' L	40' L	45' L	50' L	(Doors come in white)		
		6 Ft	Std.	Std.	Std.	Std.	Std.	Std.	Std.	Std.	6' W x 7' H \$350	
		7 Ft	\$100	\$125	\$150	\$175	\$200	\$225	\$250	8' W x 7' H \$450		
		8 Ft	\$200	\$250	\$300	\$350	\$400	\$450	\$500	9' W x 7' H \$500		
		9 Ft	\$300	\$375	\$450	\$525	\$600	\$675	\$750	10' W x 8' H \$550		
		10 Ft	\$400	\$500	\$600	\$700	\$800	\$900	\$1,000	10' W x 10' H \$600		
		11 Ft	\$500	\$625	\$750	\$875	\$1,000	\$1,125	\$1,250	Roll Up Door Side Install		
		12 Ft	\$600	\$750	\$900	\$1,050	\$1,200	\$1,350	\$1,500	Add \$150 Charge Each		
		13 Ft*	\$1,400	\$1,750	\$2,100	\$2,450	\$2,800	\$3,150	\$3,500	**Side install charge up to 10' x 10'		
		14 Ft*	\$1,600	\$2,000	\$2,400	\$2,800	\$3,200	\$3,600	\$4,000	*Leg height needs to be 1' taller than door height when installed on sides & ends		
Closed Ends Per End		Vertical Sides Add	\$250	\$300	\$350	\$400	\$450	\$500	\$550	Windows		
		Height	20' L	25' L	30' L	35' L	40' L	45' L	50' L			
		6 Ft	\$330	\$415	\$495	\$580	\$660	\$745	\$825	30" W x 30" H \$175		
		7 Ft	\$385	\$475	\$575	\$665	\$765	\$855	\$955	\$50 Fee for Installation on side wall of Vertical Building		
		8 Ft	\$460	\$575	\$685	\$805	\$920	\$1,030	\$1,135	Add'l Labor Fees		
		9 Ft	\$500	\$625	\$745	\$875	\$1,000	\$1,120	\$1,240	Starting At \$125+		
		10 Ft	\$535	\$670	\$805	\$940	\$1,075	\$1,205	\$1,340			
		11 Ft	\$615	\$765	\$920	\$1,075	\$1,230	\$1,375	\$1,530			
		12 Ft	\$640	\$800	\$960	\$1,120	\$1,280	\$1,440	\$1,600			
		13 Ft*	\$665	\$835	\$1,000	\$1,165	\$1,330	\$1,505	\$1,670			
		14 Ft*	\$745	\$930	\$1,115	\$1,300	\$1,485	\$1,675	\$1,860			
Closed Ends Per End		Vertical End Add	\$300	\$400	\$450	\$500	\$550	\$600	\$650	\$700		
		Height	12' Wide	18' Wide	20' Wide	22' Wide	24' Wide	26' Wide	28' Wide	30' Wide		
		6 Ft	\$440	\$550	\$660	\$765	\$880	\$980	\$1,100	\$1,220		
		7 Ft	\$490	\$610	\$735	\$855	\$980	\$1,060	\$1,180	\$1,305		
		8 Ft	\$545	\$675	\$810	\$945	\$1,085	\$1,135	\$1,265	\$1,395		
		9 Ft	\$595	\$740	\$890	\$1,035	\$1,190	\$1,215	\$1,350	\$1,485		
		10 Ft	\$645	\$805	\$965	\$1,125	\$1,290	\$1,315	\$1,430	\$1,570		
		11 Ft	\$725	\$905	\$1,085	\$1,215	\$1,370	\$1,400	\$1,510	\$1,655		
		12 Ft	\$800	\$990	\$1,195	\$1,305	\$1,450	\$1,485	\$1,595	\$1,745		
		13 Ft*	\$1,140	\$1,400	\$1,700	\$2,095	\$2,310	\$2,355	\$2,520	\$2,755		
		14 Ft*	\$1,245	\$1,530	\$1,855	\$2,230	\$2,415	\$2,485	\$2,640	\$2,880		
Accessories		Extra Trusses		Extra Metal Sheets		Gable (Per End)			Anchors			
		12' - 24'	\$185			Width	Std	Vertical	Concrete Free*			
		26' - 30'	\$200	36" Coverage	12' - 20'	\$175	\$225	*With installation on concrete				
		*Price for 6' tall Truss		21'	\$90	22' - 24'	\$195	\$275	Mobile Home \$30			
		Add \$15 for each foot height, up to 12' tall		26'	\$110	26' - 30'	\$275	\$375	Asphalt \$30			
		Special Orders		Connection Fee		Extended Gable (Per End)			Ask about our 90+ mph Wind Warranty			
		Heavy Duty Walk In Doors		Side to Side		Width	Std	Vertical	Welded On Brackets with Anchors			
		Insulation		20' Long \$175		12' - 20'	\$325	\$375	*On Concrete Only			
		Overhead Doors		25' Long \$200		22' - 24'	\$350	\$425				
		Color Screws		30' Long \$225		26' - 30'	\$550	\$725	Brackets with anchors \$15			
		Colored Roll Up Doors		35' Long \$250								
		Larger buildings, 32' - 80' wide, or custom size buildings available.		40' Long \$275								
				*Standard Roof Only								

We Accept:



Prices are subject to change without notice